

LOCUS MAP
N.T.S.

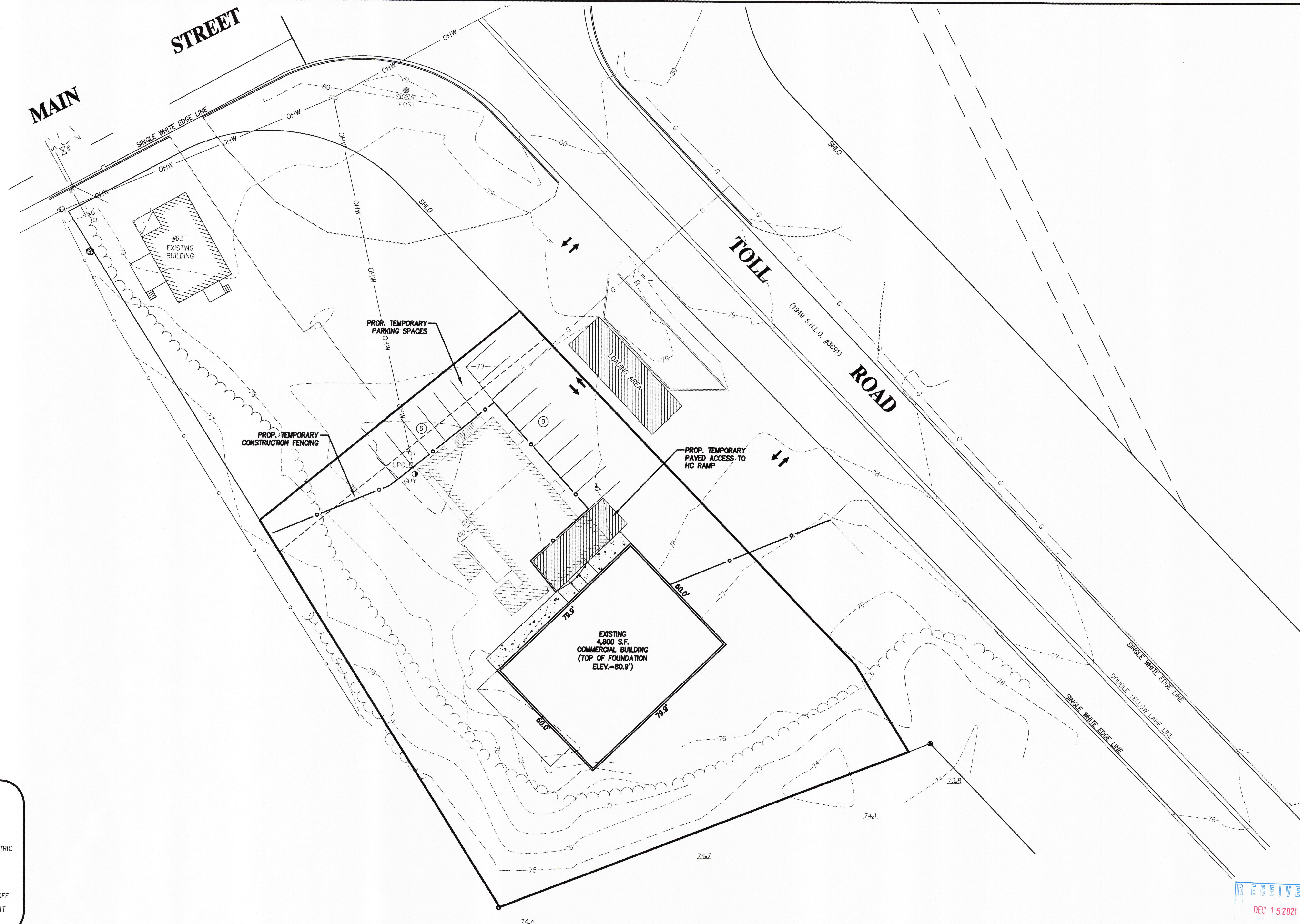

LEGEND

- W — EXISTING WATER MAIN
- OHW — EXISTING OVERHEAD WIRE
- W — PROPOSED WATER SERVICE
- UE — PROPOSED UNDERGROUND ELECTRIC
- G — PROPOSED GAS SERVICE
- ▲ PROP. SLOPED GRAN. CURB
- ▲ PROP. VERTICAL GRAN. CURB
- ★ PROP. STREET LIGHT
- ⊕ EXISTING FIRE HYDRANT
- ⊕ PROP. WATER SHUTOFF
- ⬤ PROP. BUILDING LIGHT

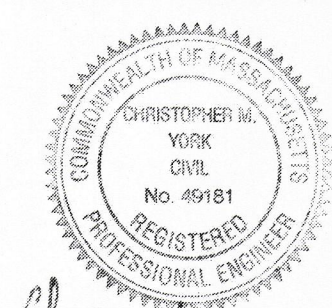
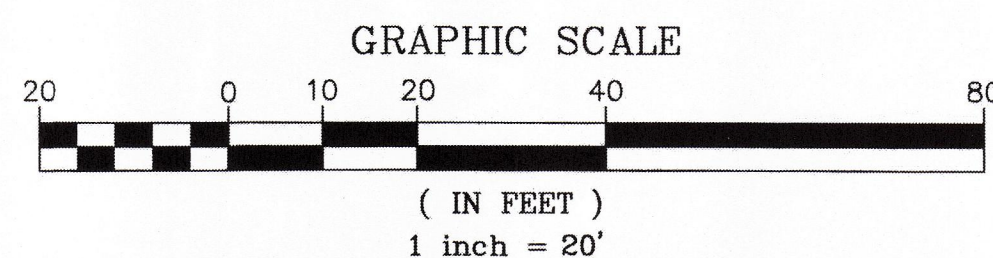

PREPARED FOR
CHIRAG REALTY, LLC
45 TOLL ROAD
SALISBURY, MA 01952

NO.	DATE	DESCRIPTION	BY
1	12-15-21	REVISE PLAN	C.M.Y.

MILLENNIUM ENGINEERING, INC.
ENGINEERING AND LAND SURVEYING
62 ELM ST. SALISBURY, MA 01952 (978) 463-8980
13 HAMPTON RD. EXETER, NH 03833 (603) 778-0528

SCALE: 1"=20'
DATE: NOV. 19, 2021
DESC. BY: C.M.Y.
CHKD. BY: E.W.B.
PROJECT: M162939

PLAN OF LAND
IN
SALISBURY, MA
TO ACCOMPANY AN APPLICATION FOR
SITE PLAN REVIEW
AT
45 TOLL ROAD

**TEMPORARY
PARKING
PLAN**
SHEET: 1 OF 1

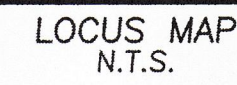

BASIS OF BEARINGS

1949 STATE HIGHWAY LAYOUT #3691

OWNER OF RECORD

CHIRAG REALTY, LLC
BK.26041 PG. 448
#45 TOLL ROAD

PLAN REFERENCES

1949 STATE HIGHWAY LAYOUT #3691
PLAN 215 OF 1977

ZONING TABLE		
ADDRESS – ASSESSORS MAP 18 LOT 227		
ZONING DISTRICT–LAFAYETTE/MAIN COMMERCIAL (LMA)		
	REQUIRED	EXISTING
LOT AREA:	29,040 S.F.	37,631 S.F.
LOT FRONTAGE:	150 FT	254.61 FT
MIN. FRONT SETBACK:	30 FT	34.3 FT
MAX. FRONT SETBACK:	50 FT	
SIDE SETBACK:	15 FT	40.7 FT
REAR SETBACK:	25 FT	53.4 FT
MIN. OPEN SPACE:	15%	61.1%
BLDG HEIGHT:	60 FT	***

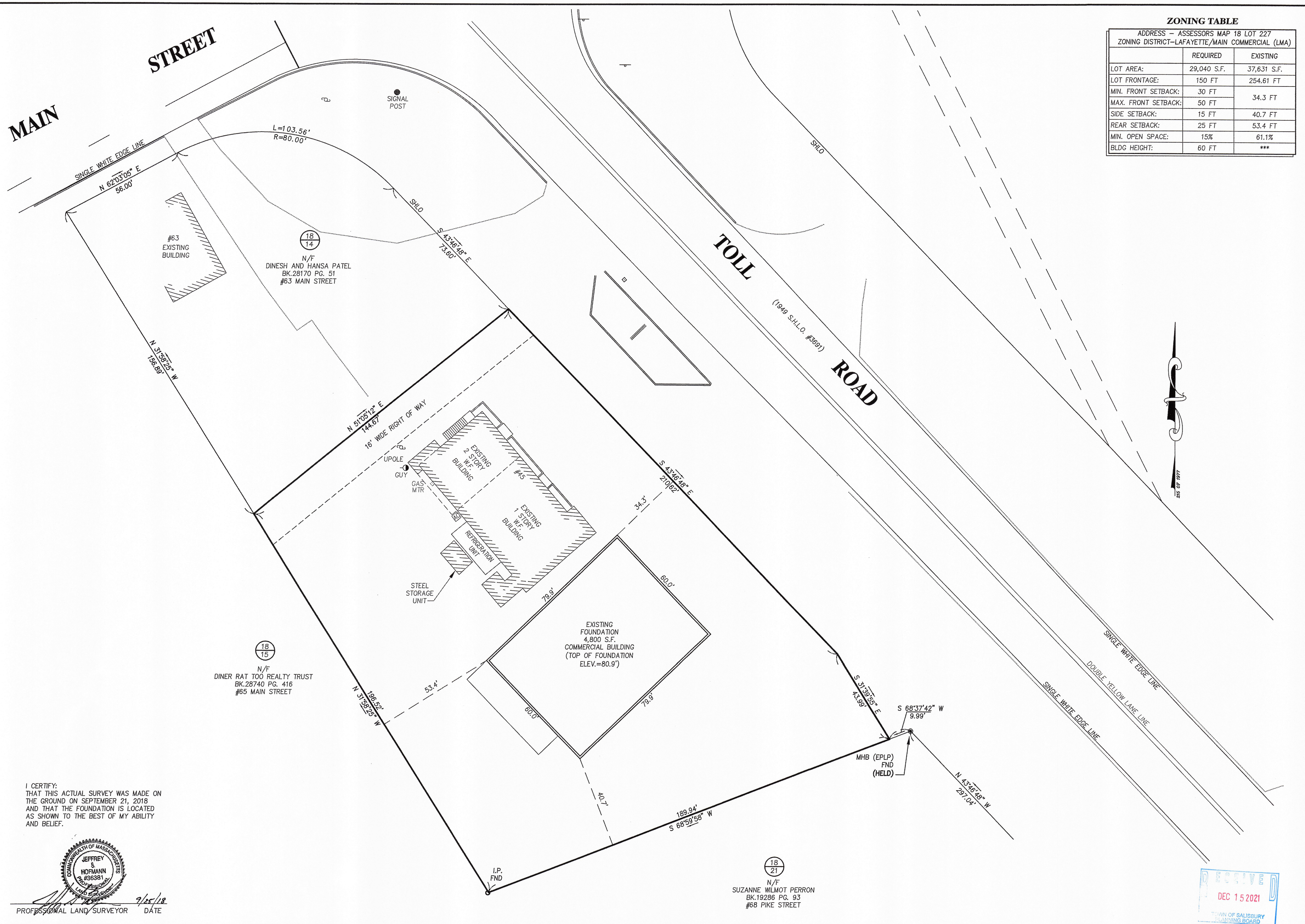

LEGEND

- | | |
|------------|-----------------------------|
| ● M.H.B. | MHB |
| ○ I.P. | IRON PIPE |
| ● E.P.L.P. | ESCUTCHEON PIN IN LEAD PLUG |
| FND. | FOUND |
| N/F | NOW OR FORMERLY |
| ☪ UPOLE | UTILITY POLE |
| ☪ | GUY |
| 0 | ASSESSORS MAP# |
| 00 | PARCEL# |

I CERTIFY:
THAT THIS ACTUAL SURVEY WAS MADE ON
THE GROUND ON SEPTEMBER 21, 2018
AND THAT THE FOUNDATION IS LOCATED
AS SHOWN TO THE BEST OF MY ABILITY
AND BELIEF.

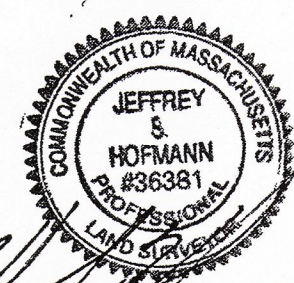

PROFESSIONAL LAND SURVEYOR DATE

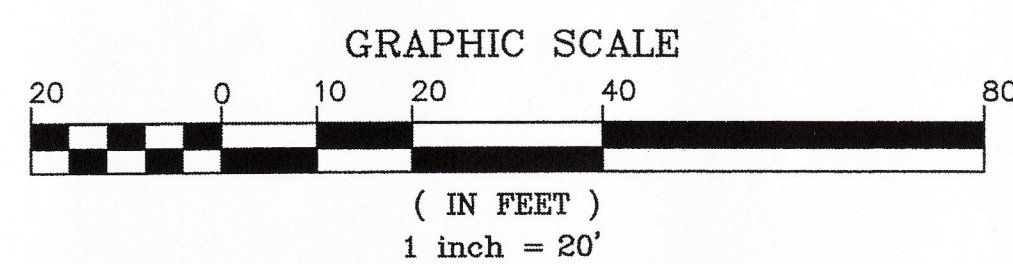

PREPARED FOR

CHIRAG REALTY, LLC
45 TOLL ROAD
SALISBURY, MA 01952

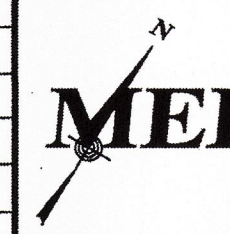
[illegible]

MILLENNIUM ENGINEERING, INC.
ENGINEERING AND LAND SURVEYING
62 ELM ST. SALISBURY, MA 01952 (978) 463-8980
13 HAMPTON RD. EXETER, NH 03833 (603)
778-0528

SCALE: 1"=20'

CALC. BY: P.D.B.

--	--

PLAN OF LAND

SALISBURY, MA

SHOWING
EXISTING FOUNDATION LOCATION
AT
45 TOLL ROAD

FOUNDATION AS-BUILT

SHEET: 1 OF 1